

6 Plymouth Road, Scunthorpe, DN17 1TL

£165,000

This three bedroom semi-detached is immaculately presented and would make a great family home or first time buy. Downstairs has a good size lounge, kitchen diner, conservatory and W.C. Upstairs has three great size double bedrooms and a modern shower room. Outside there is off road parking, a detached garage and rear garden with a patio area and a raised turfed area. Viewings are available by appointment, please get in touch to book yours.



Entrance hall

Lounge 19'11" x 15'4" (6.08 x 4.68)



Kitchen diner 19'11" x 10'9" (6.08 x 3.30)



Conservatory 9'7" x 8'7" (2.94 x 2.63 )



W.C.

Landing



Bedroom one 11'9" x 11'8" (3.60 x 3.57)



Bedroom two 12'5" x 11'8" (3.80 x 3.57)



Bedroom three 9'4" x 8'3" (2.87 x 2.52 )



Shower room



Outside





Floor Plan

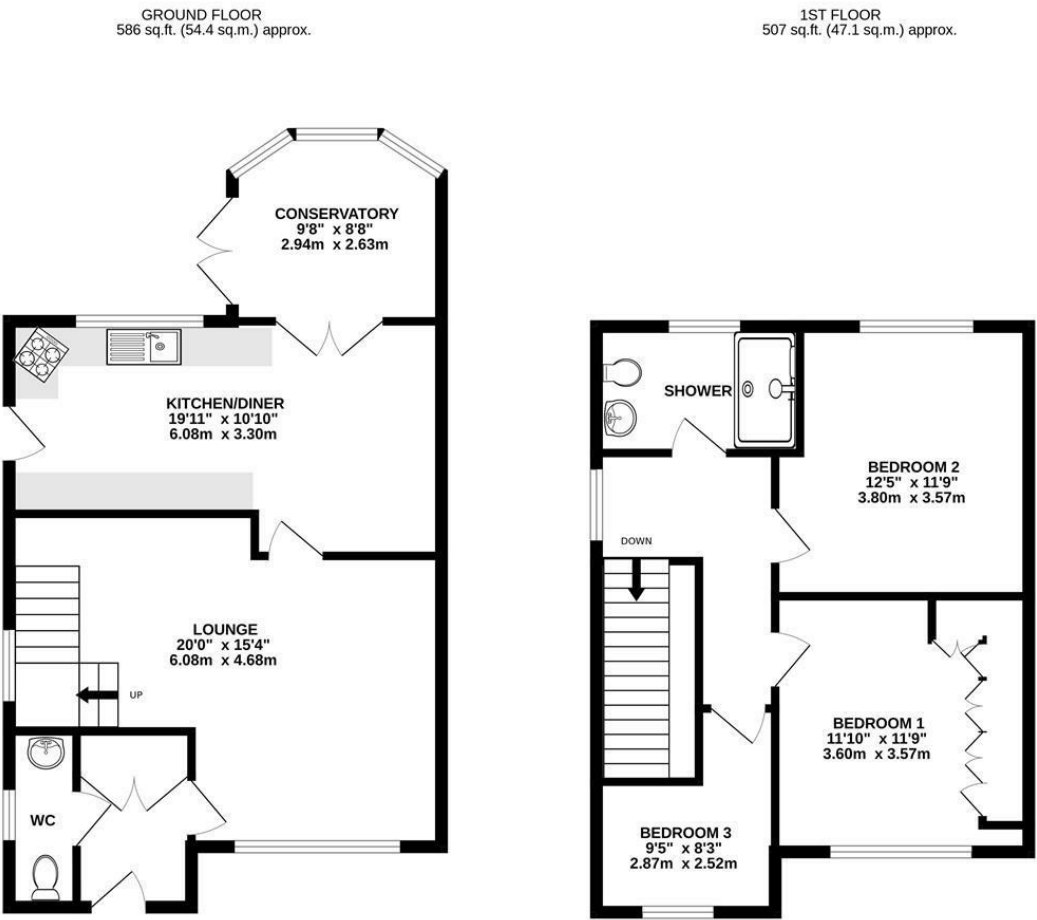

TOTAL FLOOR AREA : 1093 sq.ft. (101.6 sq.m.) approx.

Whilst every attempt has been made to ensure the accuracy of the floorplan contained here, measurements of doors, windows, rooms and any other items are approximate and no responsibility is taken for any error, omission or mis-statement. This plan is for illustrative purposes only and should be used as such by any prospective purchaser. The services, systems and appliances shown have not been tested and no guarantee as to their operability or efficiency can be given.

Made with Metropix ©2024

Area Map

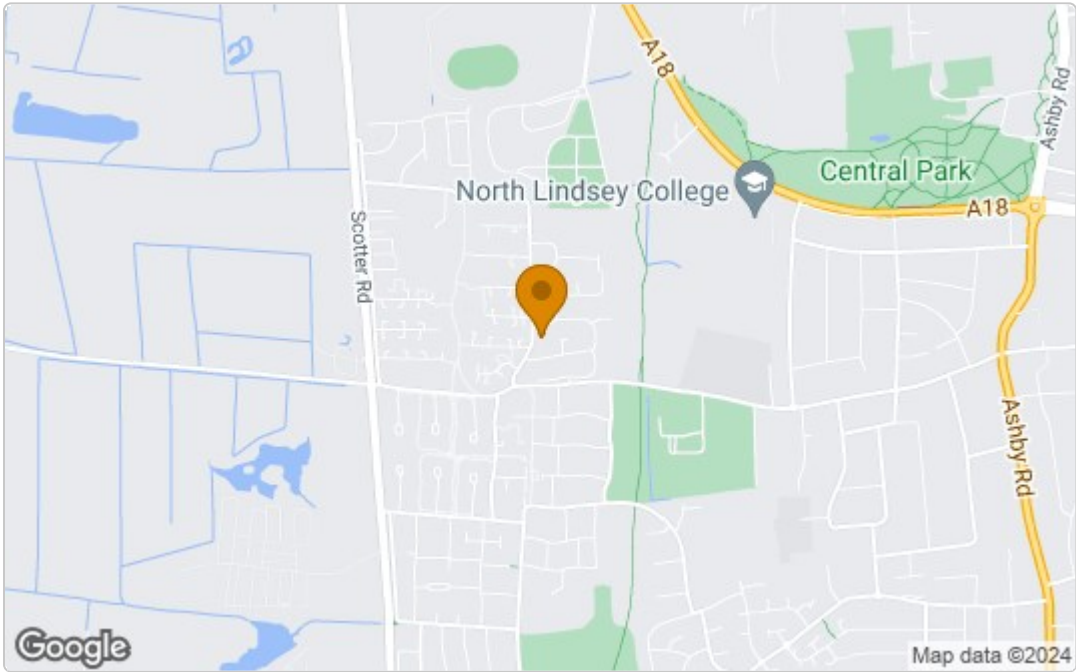

Energy Efficiency Graph

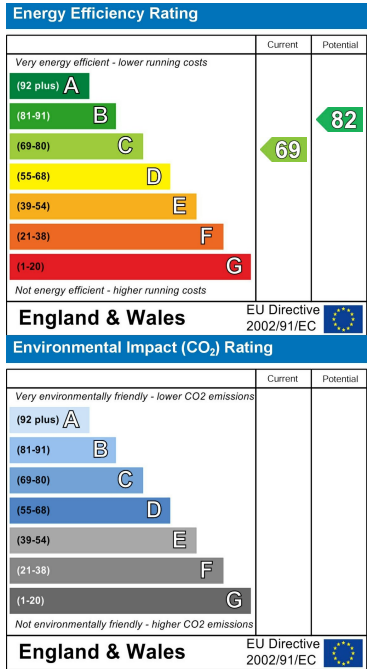

These particulars, whilst believed to be accurate are set out as a general outline only for guidance and do not constitute any part of an offer or contract. Intending purchasers should not rely on them as statements of representation of fact, but must satisfy themselves by inspection or otherwise as to their accuracy. No person in this firms employment has the authority to make or give any representation or warranty in respect of the property.